











Product Spec. Sheet

Diamond Series- 2 Monitor 2Joint Spring Arm Grommet Desk Mount LCD Monitor Arm EM45111

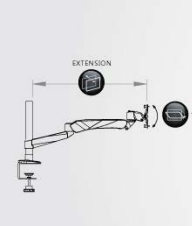
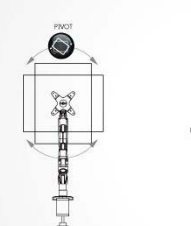
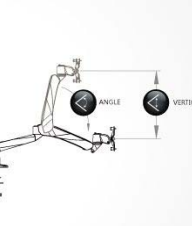
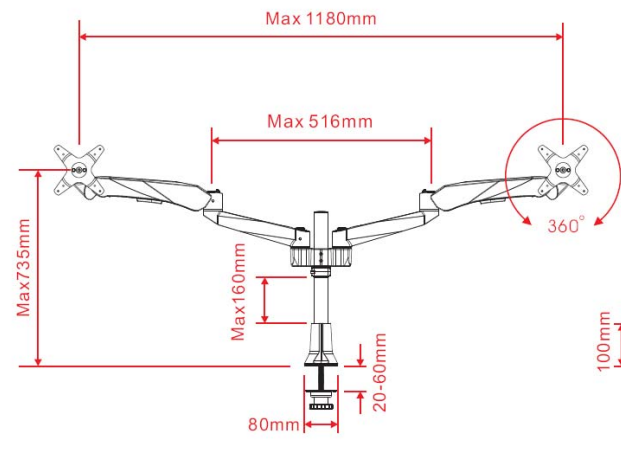
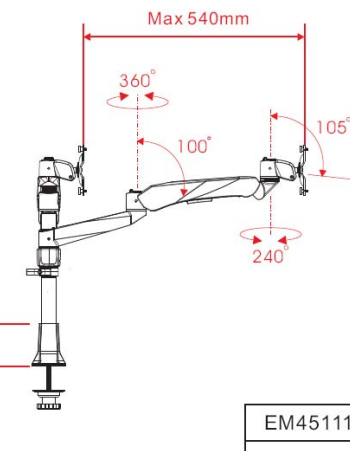

Product Name	Diamond Series- 2 Monitor 2Joint Spring Arm
Model Number (color)	EM45111 (Silver Grey)
Product Includes	2 Joint Spring Arm, Grommet desk Mount Base (Pole Length : 302mm), Dual Stand, Monitor Bracketx2
Attachment Options	 Lock for Security
Product Dimens.	L382*W136*H526mm Weight : 6.9 KG
Units per Master Carton	2 pcs
Shipping Master Carton Dimens.	L540*W297*H406 mm
Shipping Weight	N.W.:14Kg G.W.:15Kg
Units per Pallet	64 pcs
Warranty	14 Months
Weight Capacity	≤20Kg (44lbs) the max weight for single arm is ≤2Kg-9Kg (4.4-19.8lbs) almost any VESA compliant monitor up to 27"
Country of Origin	Taiwan

Features	<ol style="list-style-type: none"> 1. Elegant, Stylish and Ergonomic design with high performance 2. Wide Angle and height range for comfortable view position. 3. Swift Movement with easy adjustment. 4. 3 quick mode release function as Pivot stand, Swivel or Spring Arm. 5. Easily do install and dismount. 6. Aluminum alloy and metal material, strong and safety. 7. Internal cable management routed cables neatly under arm. 8. Space saving. 9. A considerate Tool fixed design, no more worrying tool of placement. 10. VESA MIS-D 75x75/100x100mm
Tech Specs	<div style="display: flex; justify-content: space-around; align-items: flex-end;"> <div style="text-align: center;">  VESA 160mm </div> <div style="text-align: center;">  LIFT 100° </div> <div style="text-align: center;">  ANGLE 100° </div> <div style="text-align: center;">  PIVOT 360° </div> <div style="text-align: center;">  SWIVEL 360° </div> <div style="text-align: center;">  PAN 240° </div> <div style="text-align: center;">  TILT 105° </div> <div style="text-align: center;">  EXTENSIO 540mm </div> <div style="text-align: center;">  VERTICAL 270 mm </div> <div style="text-align: center;">  Wt.Load ≤20kg </div> </div> <div style="display: flex; justify-content: space-around; margin-top: 10px;">    </div>
Drawing	<div style="display: flex; justify-content: space-around; align-items: flex-end;">   </div> <div style="border: 1px solid black; padding: 5px; width: fit-content; margin-left: auto; margin-top: 10px;"> EM45111 Unit:mm </div>



71H016135-015

1 Installation Method of Mount Type (夾座安裝方法)

A C-Clamp (C型夾)

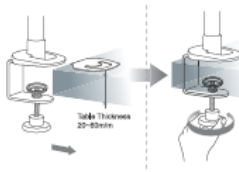

B Grommet (穿桌夾)

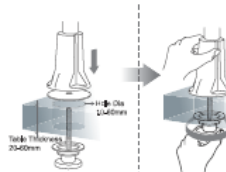

C Wall Mount (壁掛型)

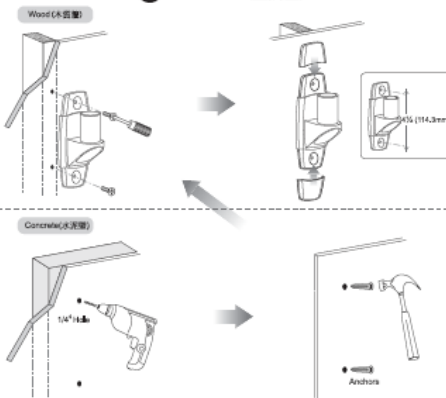

2 Install Arms (安裝支架)

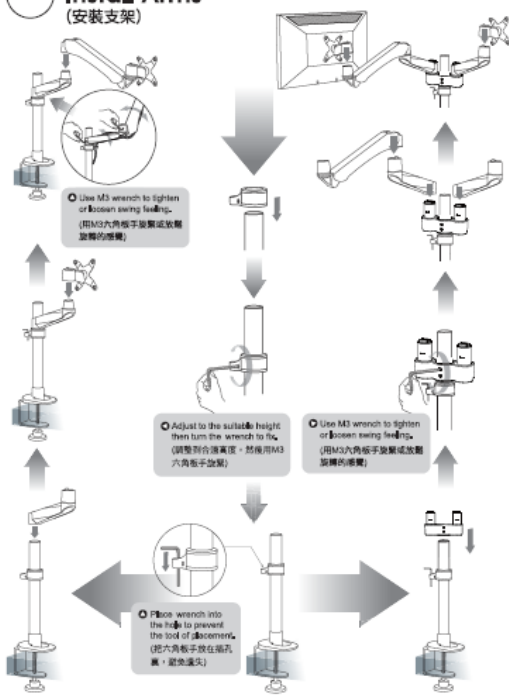

3 Install Monitors (安裝螢幕)

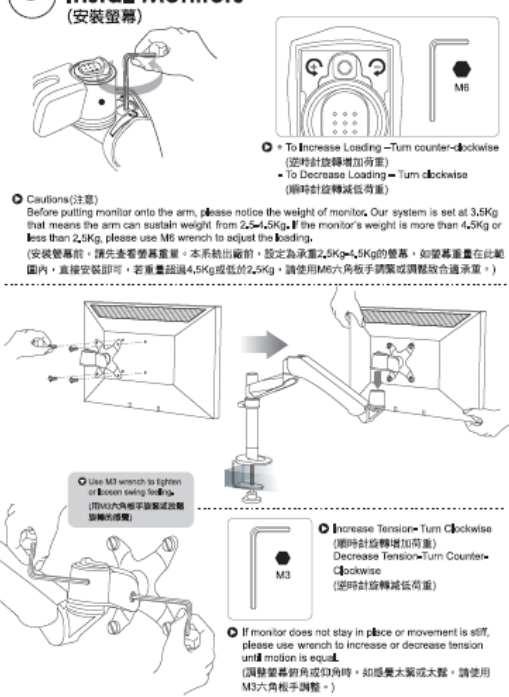











4 Route Cables (理線)

④

Model 型號		EM1111	EM1115	EM1150	EM1154	EM2011	EM2020	EM2026	EM2031	EM2035	EM2036	EM2037	EM2041	EM2042	EM2043	EM2044	EM2045	EM2046	EM2047	EM2048	EM2049	EM2050	EM2051	EM2052	EM2053	EM2054	EM2055	EM2056	EM2057	EM2058	EM2059	EM2060	EM2061	EM2062	EM2063	EM2064	EM2065	EM2066	EM2067	EM2068	EM2069	EM2070	EM2071	EM2072	EM2073	EM2074	EM2075	EM2076	EM2077	EM2078	EM2079	EM2080	EM2081	EM2082	EM2083	EM2084	EM2085	EM2086	EM2087	EM2088	EM2089	EM2090	EM2091	EM2092	EM2093	EM2094	EM2095	EM2096	EM2097	EM2098	EM2099	EM2100																																																																																																																																																																																																																																																																																																																																																																																																																																																																																																																																																																																																																																																																																																																																																																																																																																																																																																																																																																																																																																																																																																																																																																																																																																							
Parts																																																																																																																																																																																																																																																																																																																																																																																																																																																																																																																																																																																																																																																																																																																																																																																																																																																																																																																																																																																																																																																																																																																																																																																																																																																																																																															</

④

										
	VESA (75x75/100/100)	LIFT (75x75/100/100)	ANGLE (75x75/100/100)	PIVOT (75x75/100/100)	SWIVEL (75x75/100/100)	PAN (75x75/100/100)	TILT (75x75/100/100)	EXTENSION (75x75/100/100)	VERTICAL (75x75/100/100)	W/Load (75x75/100/100)
EM35111	HB0 (75x75/100/100)	200mm	0	360°	0	360°	105°	0	0	≤14kg
EM35116	HB0 (75x75/100/100)	200mm	0	360°	0	360°	105°	0	0	≤14kg
EM35138	HB0 (75x75/100/100)	200mm	0	360°	0	360°	105°	0	0	≤14kg
EM35114	HB0 (75x75/100/100)	0	0	360°	0	180°	105°	0	0	≤14kg
EM35211	HB0 (75x75/100/100)	200mm	0	360°	360°	360°	105°	210mm	0	≤14kg
EM35216	HB0 (75x75/100/100)	200mm	0	360°	360°	360°	105°	210mm	0	≤14kg
EM35238	HB0 (75x75/100/100)	200mm	0	360°	360°	360°	105°	210mm	0	≤14kg
EM35214	HB0 (75x75/100/100)	0	0	360°	180°	360°	105°	210mm	0	≤14kg
EM35311	HB0 (75x75/100/100)	200mm	0	360°	360°	360°	105°	420mm	0	≤14kg
EM35316	HB0 (75x75/100/100)	200mm	0	360°	360°	360°	105°	420mm	0	≤14kg
EM35338	HB0 (75x75/100/100)	200mm	0	360°	360°	360°	105°	420mm	0	≤14kg
EM35314	HB0 (75x75/100/100)	0	0	360°	360° *	360°	105°	420mm	0	≤14kg
EM35411	HB0 (75x75/100/100)	200mm	105°	360°	360°	240°	105°	330mm	270mm	2-9kg
EM35416	HB0 (75x75/100/100)	200mm	105°	360°	360°	240°	105°	330mm	270mm	2-9kg
EM35438	HB0 (75x75/100/100)	200mm	105°	360°	360°	240°	105°	330mm	270mm	2-9kg
EM35414	HB0 (75x75/100/100)	0	105°	360°	180°	240°	105°	330mm	270mm	2-9kg
EM34121	HB0 (75x75/100/100)	0	105°	360°	360°	240°	105°	330mm	270mm	2-9kg
EM34128	HB0 (75x75/100/100)	0	105°	360°	360°	240°	105°	330mm	270mm	2-9kg
EM34038	HB0 (75x75/100/100)	0	105°	360°	360°	240°	105°	330mm	270mm	2-9kg
EM35511	HB0 (75x75/100/100)	200mm	105°	360°	360°	240°	105°	540mm	270mm	2-9kg
EM35516	HB0 (75x75/100/100)	200mm	105°	360°	360°	240°	105°	540mm	270mm	2-9kg
EM35538	HB0 (75x75/100/100)	200mm	105°	360°	360°	240°	105°	540mm	270mm	2-9kg
EM55111	HB0 (75x75/100/100)	330mm	0	360°	360°	360°	105°	210mm	0	≤14kg
EM55116	HB0 (75x75/100/100)	330mm	105°	360°	360°	360°	105°	210mm	0	≤14kg
EM55138	HB0 (75x75/100/100)	330mm	105°	360°	360°	360°	105°	210mm	0	≤14kg
EM55211	HB0 (75x75/100/100)	330mm	0	360°	360°	360°	105°	210mm	0	≤14kg
EM55216	HB0 (75x75/100/100)	330mm	0	360°	360°	360°	105°	210mm	0	≤14kg
EM55238	HB0 (75x75/100/100)	330mm	0	360°	360°	360°	105°	210mm	0	≤14kg

1. 客戶滿意是我們努力追求的目標，為給用戶提供高質量服務及屬於消費者的權利，獲得合理價值的消費的責任。

2. 為提高服務效率，擁有維修保證及換貨服務則與質量保證並存。

3. 在購買貨品時，擁有必須換貨質量且並無扣費，如扣取運費，會由在保證期內內部免費結算。

4. 如超過保證期，消費者必須負擔零件及維修費用。

5. 保證期與質量之價格相稱，正常使用本產品，如使用會使用超過產品正常之使用量，造成產品受損故障，意在保證期內，概不負責維修。消費者必須自負零件及維修費用。

- Consumer's satisfaction with our products is great that we have been heading for. To assure the best affordable service to consumers and ensure consumer's rights, please read carefully the information stated in the instruction manual.
- To enhance our service efficiency, please purchase invoice or warranty card if request for product maintenance or merchandise exchange.
- The actual date of purchase and affected sold by distributor on warranty card is required. Free after-sales services will not be guaranteed even under warranty period should any incomplete purchase information.
- The costs of components and maintenance will be at consumer's expense should the product is invalid for warranty period.
- Please refer to specification Identification specified in the instruction manual for correct usage. Even under the warranty period, this warranty does not cover the problem or damage arising from the wrong weight used or the specification specified in the instruction manual and the use of components and maintenance for the repair.

Please lift arm up to highest position while removing the monitor. The monitor arm could bounce upward to cause personal injury when the weight of monitor is removed.

卸下螢幕時，請將支架移到最上端，因為維持平衡的螢幕重量被移開時，支架會反彈，可能會造成傷害。

