

# Product Spec. Sheet











## Diamond Series- 2-Joint Spring Arm

EM35111

Grommet Desk Mount LCD Monitor Arm

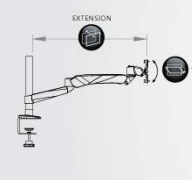
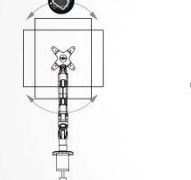
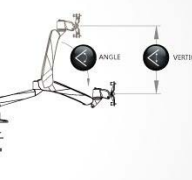
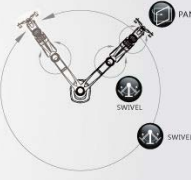
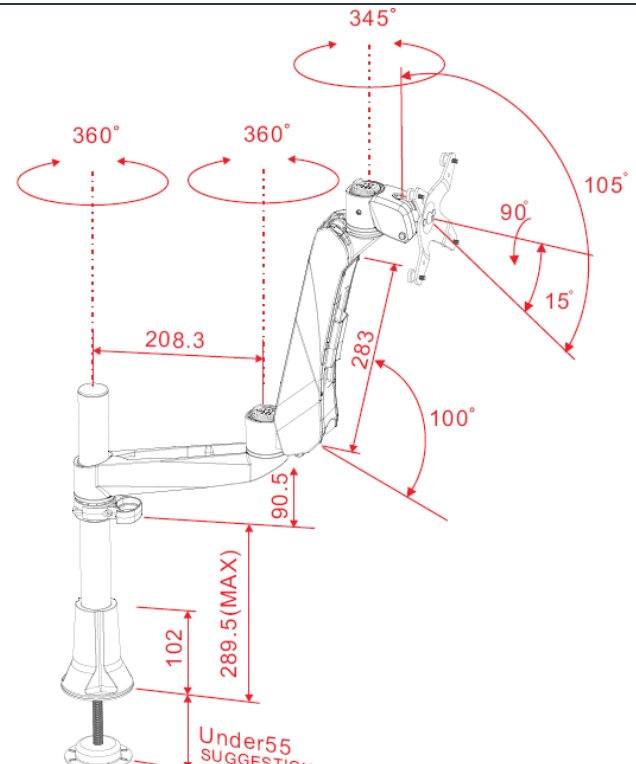

<b>Product Name</b>	Diamond Series Spring Arm
<b>Model Number (color)</b>	EM35111 (Silver Grey)
<b>Product Includes</b>	Spring Arm, extension Swivel Arm, Grommet desk Mount Base (Pole Length :302mm) Monitor Bracket
<b>Attachment Options</b>	 Lock for Security
<b>Product Dimens.</b>	Product : W120XH470XI280mm Weight : 3Kg Color Box : L290*W136*H462MM Weight : 3.7Kg
<b>Units per Master Carton</b>	5pcs
<b>Shipping Master Carton Dimens.</b>	Carton : L706*W475*H312MM
<b>Shipping Weight</b>	N.W.:18.5Kg G.W.:19.5Kg
<b>Units per Pallet</b>	90pcs
<b>Warranty</b>	14 Months
<b>Weight Capacity</b>	2Kg-9Kg (4.4-19.8lbs) almost any VESA compliant monitor up to 30"
<b>Country of Origin</b>	Taiwan

<b>Features</b>	<ol style="list-style-type: none"> <li>1. Elegant, Stylish and Ergonomic design with high performance</li> <li>2. Wide Angle and height range for comfortable view position.</li> <li>3. Swift Movement with easy adjustment.</li> <li>4. 3 quick mode release function as Pivot stand, Swivel or Spring Arm.</li> <li>5. Easily do install and dismount.</li> <li>6. Aluminum alloy and metal material, strong and safety.</li> <li>7. Internal cable management routed cables neatly under arm.</li> <li>8. Space saving.</li> <li>9. A considerate Tool fixed design, no more worrying tool of placement.</li> <li>10. VESA MIS-D 75x75/100x100mm</li> </ol>
<b>Tech Specs</b>	<div style="display: flex; justify-content: space-around; align-items: flex-end;"> <div style="text-align: center;">   VESA  0-200mm </div> <div style="text-align: center;">   LIFT  100° </div> <div style="text-align: center;">   ANGLE  100° </div> <div style="text-align: center;">   PIVOT  360° </div> <div style="text-align: center;">   SWIVEL  360° </div> <div style="text-align: center;">   PAN  240° </div> <div style="text-align: center;">   TILT  105° </div> <div style="text-align: center;">   EXTENSIO  0-540mm </div> <div style="text-align: center;">   VERTICAL  0-270mm </div> <div style="text-align: center;">   Wt.Load  2-9Kg </div> </div> <div style="display: flex; justify-content: space-around; margin-top: 10px;">     </div>
<b>Drawing</b>	



71H016135-015

## 1 Installation Method of Mount Type (夾座安裝方法)

### A C-Clamp (C型夾)

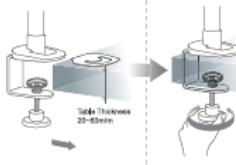

### B Grommet (穿桌夾)

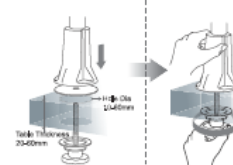

### C Wall Mount (壁掛型)

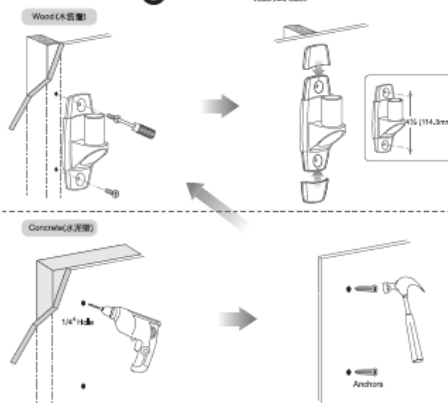

## 2 Install Arms (安裝支架)

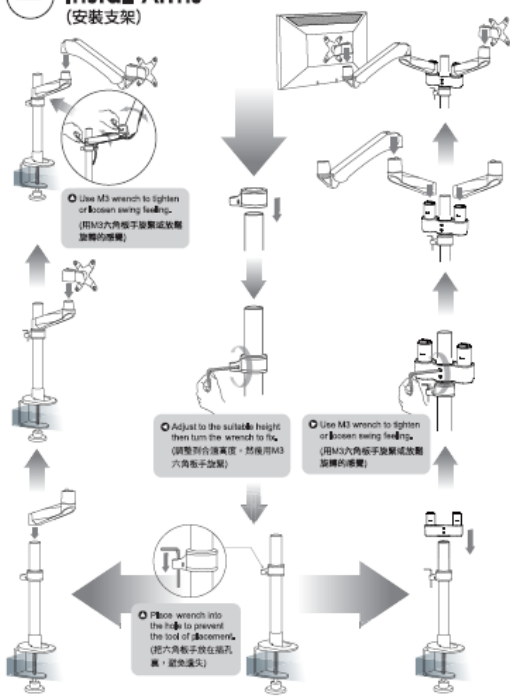

## 3 Install Monitors (安裝螢幕)

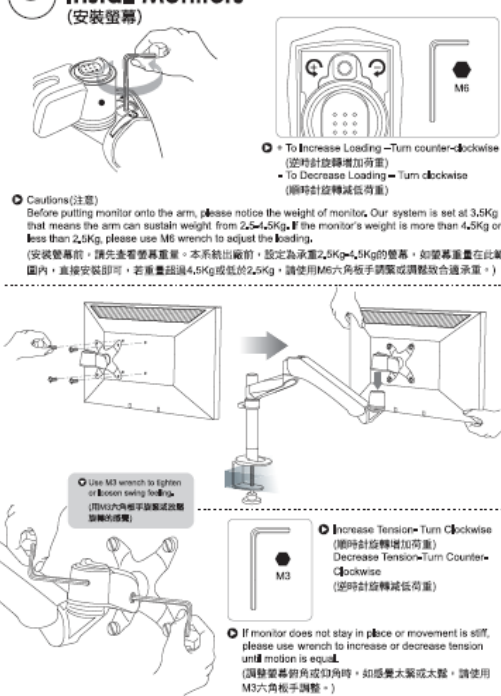











#### 4 Route Cables (理線)

①

[illegible]

①

										
	VESA	LIFT	ANGLE	PIST	SWIVEL	PAN	TILT	EXTENSION	VERTICAL	W/Load
EM31111	WFO (75x100x100)	200mm	0	360°	0	360°	105°	0	0	≤14kg
EM31116	WFO (75x100x100)	200mm	0	360°	0	360°	105°	0	0	≤14kg
EM31136	WFO (75x100x100)	200mm	0	360°	0	360°	105°	0	0	≤14kg
EM31114	WFO (75x100x100)	0	0	360°	0	180°	105°	0	0	≤14kg
EM32111	WFO (75x100x100)	200mm	0	360°	360°	360°	105°	210mm	0	≤14kg
EM32116	WFO (75x100x100)	200mm	0	360°	360°	360°	105°	210mm	0	≤14kg
EM32136	WFO (75x100x100)	200mm	0	360°	360°	360°	105°	210mm	0	≤14kg
EM32114	WFO (75x100x100)	0	0	360°	180°	360°	105°	210mm	0	≤14kg
EM33111	WFO (75x100x100)	200mm	0	360°	360°	360°	105°	420mm	0	≤14kg
EM33116	WFO (75x100x100)	200mm	0	360°	360°	360°	105°	420mm	0	≤14kg
EM33136	WFO (75x100x100)	200mm	0	360°	360°	360°	105°	420mm	0	≤14kg
EM33114	WFO (75x100x100)	0	0	360°	360°	360°	105°	420mm	0	≤14kg
EM34111	WFO (75x100x100)	200mm	100°	360°	360°	240°	105°	330mm	270mm	2-9kg
EM34116	WFO (75x100x100)	200mm	100°	360°	360°	240°	105°	330mm	270mm	2-9kg
EM34136	WFO (75x100x100)	200mm	100°	360°	360°	240°	105°	330mm	270mm	2-9kg
EM34114	WFO (75x100x100)	0	100°	360°	180°	240°	105°	330mm	270mm	2-9kg
EM34211	WFO (75x100x100)	0	100°	360°	360°	240°	105°	330mm	270mm	2-9kg
EM34216	WFO (75x100x100)	0	100°	360°	360°	240°	105°	330mm	270mm	2-9kg
EM34036	WFO (75x100x100)	0	100°	360°	360°	240°	105°	330mm	270mm	2-9kg
EM35111	WFO (75x100x100)	200mm	100°	360°	360°	240°	105°	540mm	270mm	2-9kg
EM35116	WFO (75x100x100)	200mm	100°	360°	360°	240°	105°	540mm	270mm	2-9kg
EM35136	WFO (75x100x100)	200mm	100°	360°	360°	240°	105°	540mm	270mm	2-9kg
EM35114	WFO (75x100x100)	0	100°	360°	360°	240°	105°	540mm	270mm	2-9kg
EM35121	WFO (75x100x100)	0	100°	360°	360°	240°	105°	540mm	270mm	2-9kg
EM35126	WFO (75x100x100)	0	100°	360°	360°	240°	105°	540mm	270mm	2-9kg
EM35136	WFO (75x100x100)	0	100°	360°	360°	240°	105°	540mm	270mm	2-9kg
EM35114	WFO (75x100x100)	160mm	0	360°	360°	360°	105°	420mm	0	Not Meeting ≤20kg
EM35121	WFO (75x100x100)	160mm	0	360°	360°	360°	105°	420mm	0	Not Meeting ≤20kg
EM35126	WFO (75x100x100)	160mm	0	360°	360°	360°	105°	420mm	0	Not Meeting ≤20kg
EM35136	WFO (75x100x100)	160mm	0	360°	360°	360°	105°	420mm	0	Not Meeting ≤20kg
EM35114	WFO (75x100x100)	160mm	100°	360°	360°	240°	105°	540mm	270mm	Each Arm ≤9kg
EM35121	WFO (75x100x100)	160mm	100°	360°	360°	240°	105°	540mm	270mm	Each Arm ≤9kg
EM35126	WFO (75x100x100)	160mm	100°	360°	360°	240°	105°	540mm	270mm	Each Arm ≤9kg
EM35136	WFO (75x100x100)	160mm	100°	360°	360°	240°	105°	540mm	270mm	Each Arm ≤9kg
EM35114	WFO (75x100x100)	160mm	100°	360°	360°	240°	105°	540mm	270mm	Each Arm ≤9kg
EM35121	WFO (75x100x100)	160mm	100°	360°	360°	240°	105°	540mm	270mm	Each Arm ≤9kg
EM35126	WFO (75x100x100)	160mm	100°	360°	360°	240°	105°	540mm	270mm	Each Arm ≤9kg
EM35136	WFO (75x100x100)	160mm	100°	360°	360°	240°	105°	540mm	270mm	Each Arm ≤9kg

保固條款 (Scope of Guarantee)

9. 買方購買產品時均應認明並注意，如欲轉售須將原廠商之保證書及關於其權利之資料，一併移轉與獲准承購人所有。賣方不負責任因未提供此等資料而產生之損失。
10. 本廠生產之各種零件、機件或附件均由原廠直接供應保證安全及品質。
11. 本廠所售貨物，不論何種機器以及已裝設之零件，如發生變更，皆會造成不良影響而危及人身安全。
12. 本廠所售貨物，不論何種機器以及已裝設之零件，如發生變更，皆會造成不良影響而危及人身安全。
13. 本廠對零件之使用有嚴格限制，正字標記為憑，說明書內所列零件之使用期限，即為最長使用期限。若在該期限內，不滿意請與原廠或經銷商進行更換及維修服務。
14. Consumer's satisfaction with our products is the goal that we have been heading for. To assure the best after-sale service to consumer and ensure consumer's rights, please send carefully the information stated in the instruction manual.
15. To enhance our service efficacy, please provide invoice or warranty card if requested for product maintenance or maintenance exchange.
16. The actual date of purchase and effort used by distributor on warranty card is required. Free after-sale services will not be guaranteed without proof of purchase from the manufacturer or its authorized agent.
17. All the costs of components and maintenance will be at customer's expense should the product is ill-suited for warranty period.
18. Please refer to specification Instruction specified in the instruction manual for correct usage. Even under the warranty period, this warrant does not cover the problems or damage resulting from the loading weight that exceeds the specification specified in the instruction manual.

Please lift arm up to highest position while removing the monitor. The monitor arm could bounce upward to cause personal injury when the weight of monitor is removed.

卸下螢幕時，請將支架移到最上端，因為維持平衡的螢幕重量被移開時，支架會反彈，可能會造成傷害。

